

MOLTERA[®]
QUARTZ SINK

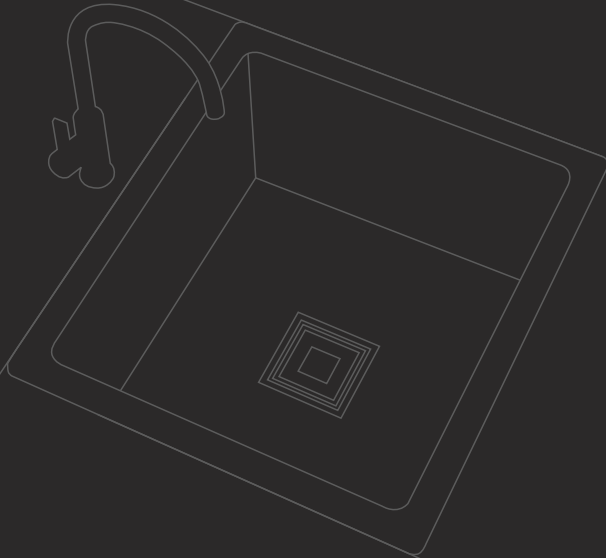

★ ★ ★
PREMIUM
Quartz
KITCHEN SINK

PRODUCT
CATALOGUE - 2024



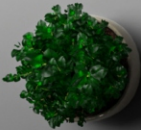
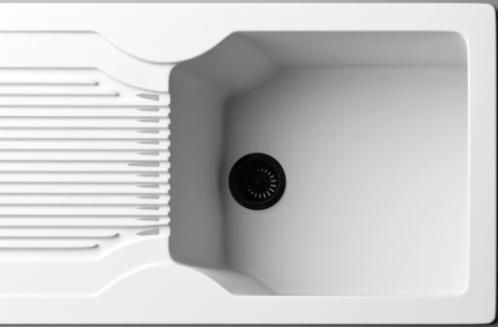

Presenting grandeur around you

We aim to provide an Eccentric Design for individualistic choices. Our collection is very vivid and different to grasp the aspect of Classique our focus is to stay upgraded and deliver modernistic and authentic styles. We make sure to innovate and bring forth top-notch Quality.



Quality is our Culture

Quality Features

The material that we use is exuberantly qualitatively perfect. Keeping in mind its use, it is made such that it can be easily cleaned, and shine is retained. For your safety regarding health, it is also anti-bacterial and hygienic surface providing high-caliber durability for regular use. It is stain, thermal shock, and impact resistant for longer durability. It has a uniform structure that gives it a supreme finish.



Easy To Clean



Anti-Bacterial Surface



Scratch Resistant



Wide Colour Palette



Full Body Non-Porous Material



Thermal Shock Resistant



Hygienic Surface



Stain Resistant



Impact Resistant



Uniform Structure



High Caliber Durability



Noise Less



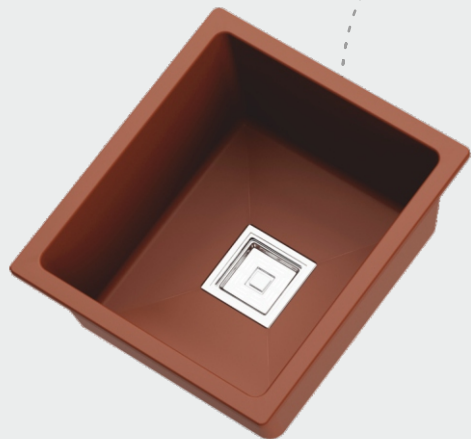

Pearl Brown

Length	:	16 Inch
Width	:	18 Inch
High	:	8 Inch
Thickness	:	12mm
Weight	:	9.0 Kgs. (Approx)
Finish	:	Granite, Metallic
Accessories	:	Waste Coupling Waste Pipe

M.R.P. :

Granite	Metallic
5199.00	6199.00

Dimensions

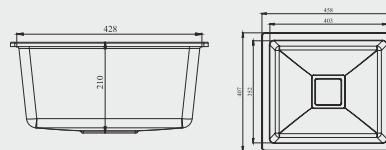

Upgrading to a Marvelous look

It is the colour of nature bringing it inside the interiors of your home. A majestic shade having supreme quality for the user's hygiene.

Installation



Top Mount Flush Mount Under Mount



Pearl Brown
18X16 IN

Quartz
KITCHEN SINK

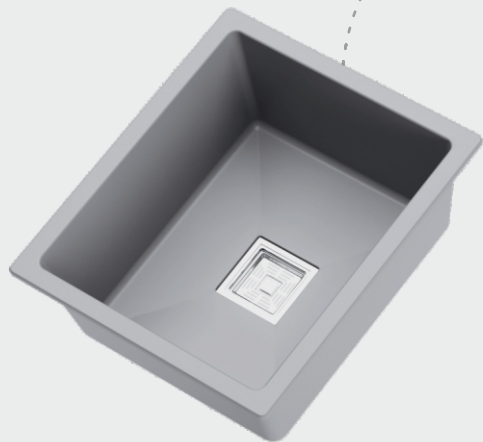

Crystal Grey

Length	:	18 Inch
Width	:	21 Inch
High	:	9 Inch
Thickness	:	12mm
Weight	:	11.0 Kgs. (Approx)
Finish	:	Granite, Metallic
Accessories	:	Waste Coupling Waste Pipe

M.R.P. :

Granite	Metallic
6199.00	7199.00

Dimensions

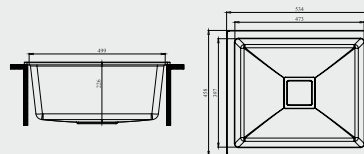

Instilling aesthetic creativity

A grey shade sink is something flamboyantly stylish. Integration of white and black into a color that elevates your decor's look.

Installation



Top Mount Flush Mount Under Mount



Crystal Grey
21X18 IN

Quartz
KITCHEN SINK

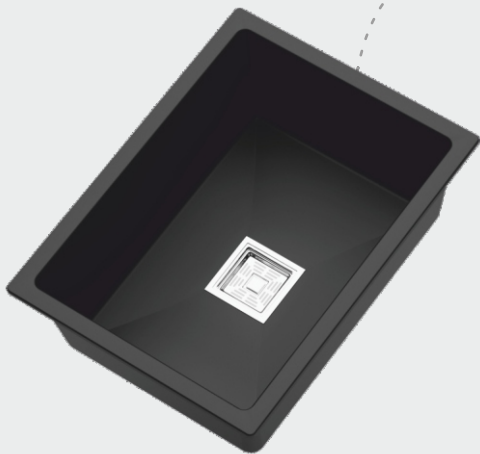

Marvel Black

- Length : 18 Inch
Width : 24 Inch
High : 9 Inch
Thickness : 12mm
Weight : 13.0 Kgs. (Approx)
Finish : Granite, Metallic
Accessories : Waste Coupling | Waste Pipe

M.R.P. :

Granite	Metallic
7199.00	8199.00

Dimensions

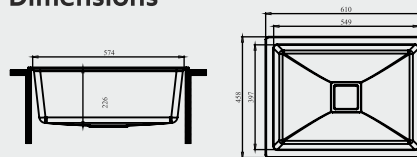

A style that lasts forever

Black sinks give an air of ever-lasting features. It looks flamboyantly classy and elevates the whole look by standing bold and in contrast to the surroundings.

Installation



Top Mount Flush Mount Under Mount



Marvel Black
24X18 IN

Quartz
KITCHEN SINK



Imperial White

- Length : 18 Inch
 Width : 36 Inch
 Height : 9 Inch
 Thickness : 12mm
 Weight : 18.0 Kgs. (Approx)
 Finish : Granite, Metallic
 Accessories : Waste Coupling | Waste Pipe

M.R.P. :

Granite	Metallic
11199.00	11999.00

Dimensions

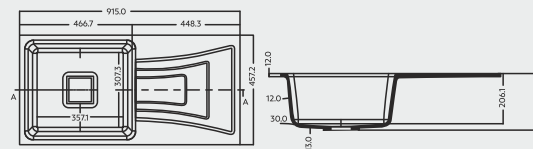

Unveiling beauty with simplicity

Experience the epitome of style and sophistication with our meticulously crafted sinks that are designed to withstand the test of time.

Installation



Top Mount Flush Mount Under Mount



Imperial White
36X18 IN

Quartz
KITCHEN SINK

Fortune Brown

- Length : 18 Inch
 Width : 36 Inch
 High : 9 Inch
 Thickness : 12mm
 Weight : 18.0 Kgs. (Approx)
 Finish : Granite, Metallic
 Accessories : Waste Coupling | Waste Pipe

M.R.P. :

Granite	Metallic
11199.00	11999.00

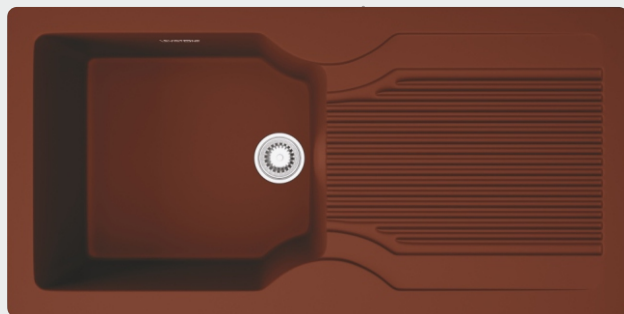

Dimensions

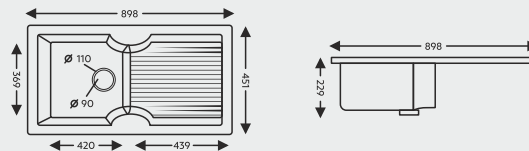

Unleash the art of craftsmanship

A beautifully crafted sink with a seamless design that enhances the overall aesthetic of your kitchen to create a stylish and sophisticated atmosphere.

Installation



Top Mount Flush Mount Under Mount



Fortune Brown
36X18 IN

Quartz
KITCHEN SINK

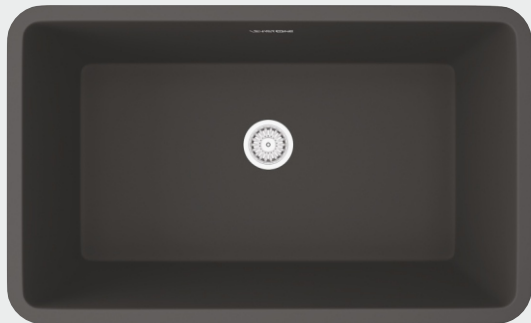

Fusion Black

Length	:	19 Inch
Width	:	31 Inch
Height	:	9 Inch
Thickness	:	12mm
Weight	:	14 Kgs. (Approx)
Finish	:	Granite, Metallic
Accessories	:	Waste Coupling Waste Pipe

M.R.P. :

Granite	Metallic
10199.00	10999.00

Dimensions

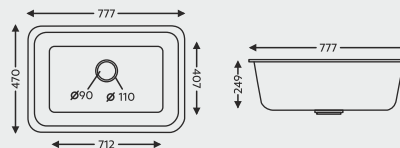

Installation



Top Mount Flush Mount Under Mount

Embrace the uniqueness

Unleash the allure of exclusivity in your space. Whether you are looking for a minimalist look or something bold or subtle, this color will enhance any area.



Fusion Black
31X19 IN

Quartz
KITCHEN SINK



Galaxy Grey

- Length : 20 Inch
Width : 30 Inch
Height : 9 Inch
Thickness : 12mm
Weight : 17 Kgs. (Approx)
Finish : Granite, Metallic
Accessories : Waste Coupling | Waste Pipe

M.R.P. :

Granite	Metallic
11199.00	11999.00

Dimensions

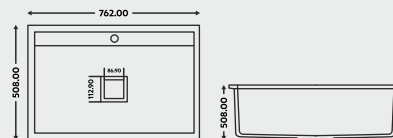

Installation



Top Mount Flush Mount Under Mount

Elegant essence for perfection

Transform your kitchen into a luxurious oasis with our stunning sink, where functionality meets elegance.



Galaxy Grey
30X20 IN

Quartz
KITCHEN SINK

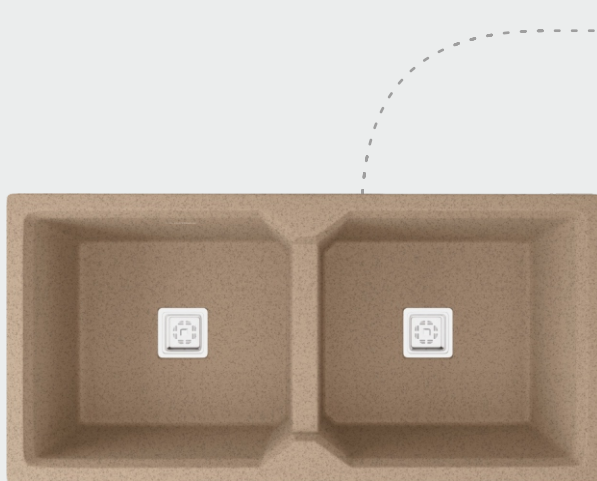

Matrix Almond

- Length : 18 Inch
Width : 37 Inch
Height : 9 Inch
Thickness : 12mm
Weight : 22 Kgs. (Approx)
Finish : Granite, Metallic
Accessories : Waste Coupling | Waste Pipe

M.R.P. :

Granite	Metallic
13199.00	13999.00

Dimensions

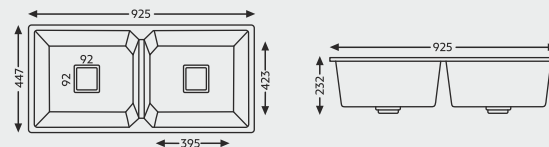

A touch of sophistication

Indulge in the beauty of our sinks: designed to make a statement in any space that deserves a touch of luxury.

Installation



Top Mount Flush Mount Under Mount



Matrix Almond
37X18

Quartz
KITCHEN SINK

Prada Silver

- Length : 20 Inch
Width : 40 Inch
Height : 9 Inch
Thickness : 15mm
Weight : 19 Kgs. (Approx)
Finish : Granite, Metallic
Accessories : Waste Coupling | Waste Pipe

M.R.P. :

Granite	Metallic
12199.00	12999.00

Dimensions

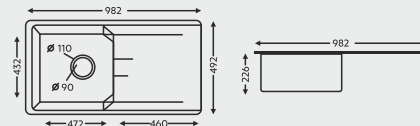

Effortless elegance, timeless charm

A beautifully crafted sink with a seamless design that enhances the overall aesthetic of your kitchen to create a stylish and sophisticated atmosphere.

Installation



Top Mount Flush Mount Under Mount



Prada Silver
40X20 IN

Quartz
KITCHEN SINK



Thar Almond

- Length : 20 Inch
- Width : 40 Inch
- High : 9 Inch
- Thickness : 12mm
- Weight : 27.0 Kgs. (Approx)
- Finish : Granite, Metallic
- Accessories : Waste Coupling | Waste Pipe

M.R.P. :

Granite	Metallic
15199.00	15999.00

Dimensions

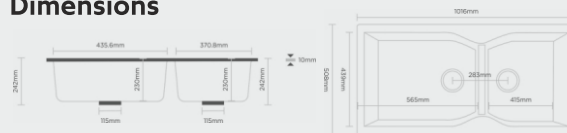

Explore the creative individuality

The almond color sink gives a royal vintage vibe to aesthetic and historically styles places. The quality can be maintained at its best through proper use.

Installation



Top Mount Flush Mount Under Mount



Thar Almond
40X20 IN

Quartz
KITCHEN SINK

Rock Black

- Length : 20 Inch
Width : 45 Inch
Height : 9 Inch
Thickness : 12 mm
Weight : 28 Kgs. (Approx)
Finish : Granite, Metallic
Accessories : Waste Coupling | Waste Pipe

M.R.P. :

Granite	Metallic
19199.00	19999.00

Dimensions

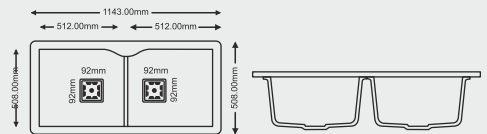

Embrace the art of refinement

A sleek and modern sink that adds a touch of elegance to any bathroom and complements contemporary decor.

Installation



Top Mount Flush Mount Under Mount



Rock Black
45X20 IN

Quartz
KITCHEN SINK

Royal Alaska

- Length : 20 Inch
Width : 45 Inch
Height : 9 Inch
Thickness : 12mm
Weight : 27 Kgs. (Approx)
Finish : Granite, Metallic
Accessories : Waste Coupling | Waste Pipe

M.R.P. :

Granite	Metallic
19199.00	19999.00

Dimensions

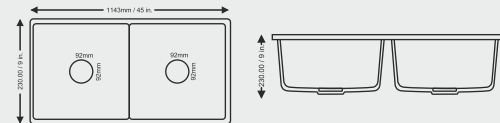

Enhancing your everyday oasis

Enhance your space's aesthetic appeal with our artistically designed sink that is sure to impress anyone.

Installation



Top Mount Flush Mount Under Mount



Royal White
45X20 IN

Quartz
KITCHEN SINK

METALLIC SERIES



WHITE



GREY

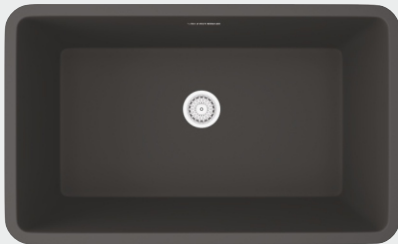

BLACK



BROWN

GRANITE SERIES



ALASKA

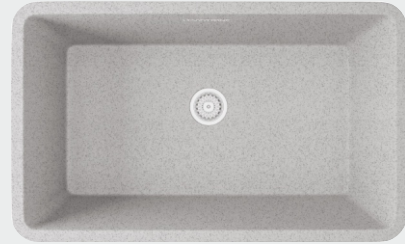

SILVER



ALMOND

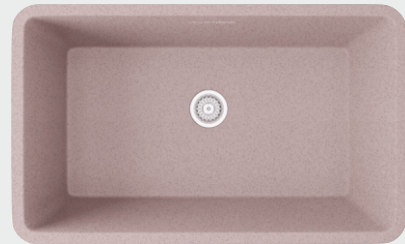

ROSE

INSTALLATION SINK

STEP 1

Proceed to remove the sink out of its box. Lift the sink and turn it upside down and place it on the counter top to trace the measurements of the cutout. It is crucial that the measurements are exact.

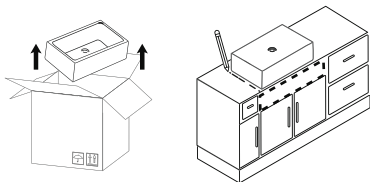

STEP 2

Cut the front of the cabinet according to the tracing. Make sure to sand down the interior wall openings of the cabinet to ensure that no damage occurs to the sink. Farmhouse sinks require a support frame because of their weight and installation method. Support types can be customized and made to accommodate different kitchen cabinets. Solid wood is recommended in creating the support frame. Due to the variety of installation methods as well as the custom nature of kitchen cabinetry, we cannot suggest a specific design for the support frame. However, the frame must be able to withstand a minimum 300 lb. weight. The below example is just a common method of installation that accommodates most kitchen cabinets. This is NOT a required nor preferred method of creating a support frame for our products, but rather an illustrative guide

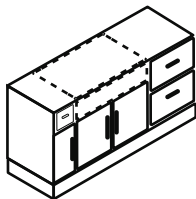

STEP 3

Having already cut the front of the cabinet according to the tracing, take a pencil and mark on the inside of the cabinet walls where the base of the sink will sit. Double check to see that the sink aligns properly with the method of installation that you have chosen (under-mount, flush mount, or top mount). Ensure to double check this and measure with a level bar

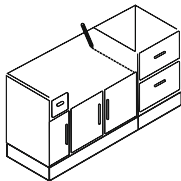

STEP 4

Next, take your 2x4's and install them on the left and right side of the interior of the kitchen cabinet. Make sure to use screws that will not drill completely through to the opposite side of the cabinet as this could cause aesthetic and structural damage

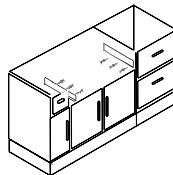

STEP 5

Create support frames below the 2x4's to ensure a rigid structure has been created. Depending on the structure and composition of the kitchen cabinet, an alternative reinforcement can be made on the back of the interior kitchen cabinet

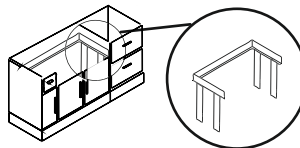

STEP 6

Next, cut a piece of plywood on which the farmhouse sink will be sitting on. Make sure to measure and cut any drain holes for plumbing connections

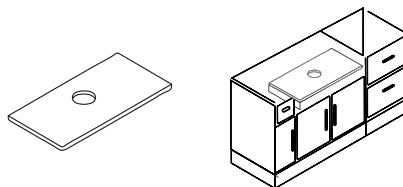

INSTALLATION SINK

STEP 7

Test the structure by gently placing the sink onto the support. Ensure that the sink is sitting level and the created support frame can withstand the weight of the sink.

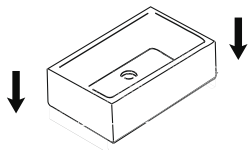

STEP 8

Having created the support frame, the next step will be to place the sink into the cutout space. Using 2 people, gently lift and carry the sink, making sure that the kitchen sink sits snug in the cutout space.

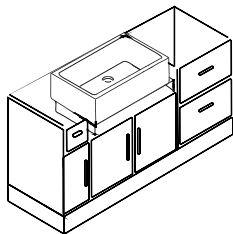

STEP 9

Having verified this, place the sink into the cutout space. Apply silicone sealant around the top of the sink and countertop. Wipe away any excess silicone. Check the surrounding space to make sure that the sink is sitting level with the cabinet.

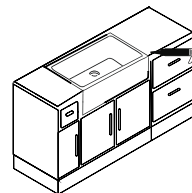

STEP 10

If you have bought any kitchen faucets or drainage systems, this would be the time to connect and install these items as per the manufacturer's installation instructions.

